

THE WESTIN AUSTIN DOWNTOWN

At The Westin Austin Downtown, we know that when you feel your best you can truly be your best and that means paying careful attention to the most important elements of your stay. When you hold your events at a Westin hotel, we remove the distractions so your group can focus in a calm and comfortable environment.

THE WESTIN AUSTIN DOWNTOWN
310 East 5th Street
Austin, Texas 78701 USA
T 512.391.2333 F 512.320.0333
westinaustindowntown.com

Meetings Set for Success

Experience the energy of the Live Music Capital of the World® at its very best with a stay at the city's most desired upscale hotel, The Westin Austin Downtown.

With 16 meeting rooms and more than 19,000 square feet of function space, our hotel can accommodate events and special occasions with as few as 10 guests or as many as 400. All of our meeting spaces, including the 4,500-square-foot Continental Ballroom, can be arranged in a variety of configurations to suit your needs. A wide range of audiovisual and technology services are also available.

Our Clutter-Free Meetings help planners and guests stay organized and productive with an open room design, socially conscious amenities and delicious SuperFoodsRxSM menu choices to keep minds sharp. Getting married? Our dedicated wedding specialist can help turn your dream of the perfect day into a reality.

With our inspiring event venues and invigorating amenities and surroundings, The Westin Austin Downtown provides one of the best destinations in the city for business functions, weddings and other special events.

Rest Assured

Each of our 366 guestrooms and suites are furnished with signature amenities designed to make you feel better than when you arrived. Dream away in a Westin Heavenly Bed® and experience the soothing Heavenly Shower/Bath®.

Other in-room amenities include high-speed Internet access, a dual-line cordless phone with data port, plush robes, work desk with an ergonomic chair, refreshment center, safe, iHome docking station and complimentary fresh-brew Starbucks® coffee and Tazo® tea. Westin also offers guests a 100% smoke-free environment.

Thoughtful Extras

Let us take care of you with Service Express®, high-speed Internet access and concierge service.

Fitness & Free Times

Enjoy spectacular city views as you energize in our rooftop pool or 24/7 WestinWORKOUT® Fitness Studio, featuring weight machines, free weights, cardio equipment with personal iPod docking stations and flat-screen televisions.

So you can pack light, we also provide New Balance® shoes and athletic wear for you to use during your stay.

Eat & Drink Well

Our full-service restaurant, Stella San Jac, features an open kitchen and outdoor seating, as well as a bar and lounge with a relaxed setting where you can enjoy light snacks and live music. Grab a quick bite along with nourishing fresh juices and smoothies at Westin Fresh by The Juicery. All of our menus offer nutritious SuperFoodsRx choices for adults, and with The Westin Eat Well Menu for Kids, children can enjoy healthy choices too. We also offer 24-hour in-room dining, highlighted by The Westin Sleep Well menu, a signature program with special cuisine and beverage options that promote a restful night's sleep, the key to renewal.

Perfectly Located

Conveniently, Austin-Bergstrom International Airport (AUS) is eight miles away, The Austin Convention Center is just blocks from the hotel and we are within walking distance to three different entertainment districts. Also a close walk away, discover the latest foodie hotspots, historic sites, legendary live music venues, eclectic shops and year-round outdoor fun. Allow our concierge to help you plan your exploration throughout Austin, whether by foot, bike, boat, bus, car or even kayak or Segway.

To begin planning your next Westin event, please visit westinaustindowntown.com



FLOOR PLANS & CAPACITY CHART

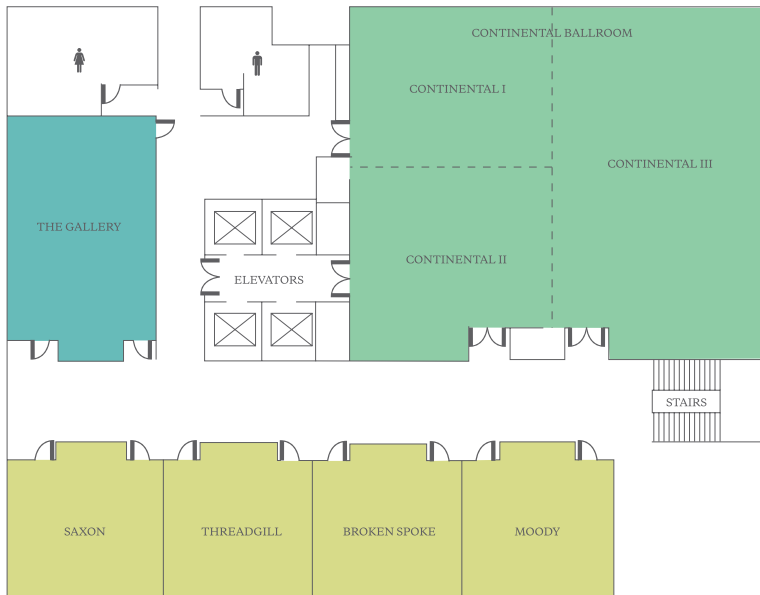

THIRD FLOOR

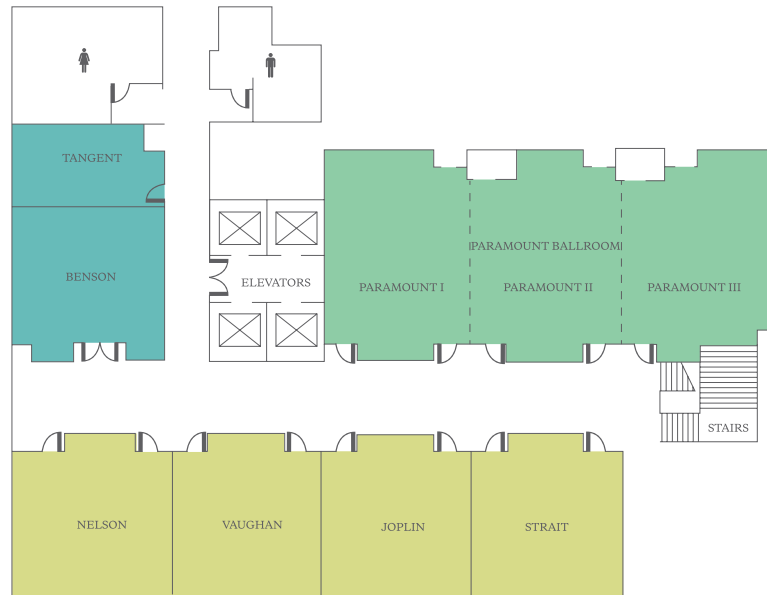

SECOND FLOOR

ROOM NAME	TOTAL SQ. FEET	DIMENSIONS	CEILING	THEATER	CLASSROOM	CONFERENCE	U-SHAPE	HOLLOW SQUARE	RECEPTION	BANQUET
THIRD FLOOR										
CONTINENTAL BALLROOM	4,464	62' X 72'	16'	480	270	—	—	—	400	300
CONTINENTAL I	1,044	29' X 36'	16'	120	54	25	29	36	100	90
CONTINENTAL II	1,120	32' X 35'	16'	120	54	25	29	36	100	90
CONTINENTAL III	2,232	62' X 36'	16'	240	132	—	53	—	200	150
THE GALLERY	1,040	40' X 26'	10'	80	63	36	37	44	111	60
SAXON	621	23' X 27'	11.5'	72	45	28	21	28	65	40
THREADGILL	598	23' X 26'	11.5'	72	45	28	21	28	65	40
BROKEN SPOKE	598	23' X 26'	11.5'	72	45	28	21	28	65	40
MOODY	621	23' X 27'	11.5'	72	45	28	21	28	65	40
SECOND FLOOR										
PARAMOUNT BALLROOM	2,730	35' X 78'	11.5'	294	150	—	—	—	275	210
PARAMOUNT I	910	35' X 26'	11.5'	98	45	28	29	36	95	70
PARAMOUNT II	884	34' X 26'	11.5'	98	45	28	29	36	95	70
PARAMOUNT III	945	35' X 27'	11.5'	98	45	28	29	36	95	70
BENSON	624	24' X 26'	11.5'	—	—	14	—	—	—	—
NELSON	700	25' X 28'	11.5'	72	45	28	21	28	70	40
VAUGHAN	650	25' X 26'	11.5'	72	45	28	21	28	70	40
JOPLIN	650	25' X 26'	11.5'	72	45	28	21	28	70	40
STRAIT	675	25' X 27'	11.5'	72	45	28	21	28	70	40

